

**PART  
SMART**

powered by:



NEXT LEVEL KNOWLEDGE.

# INSTALLATION BEST PRACTICES

## | Brake Calipers

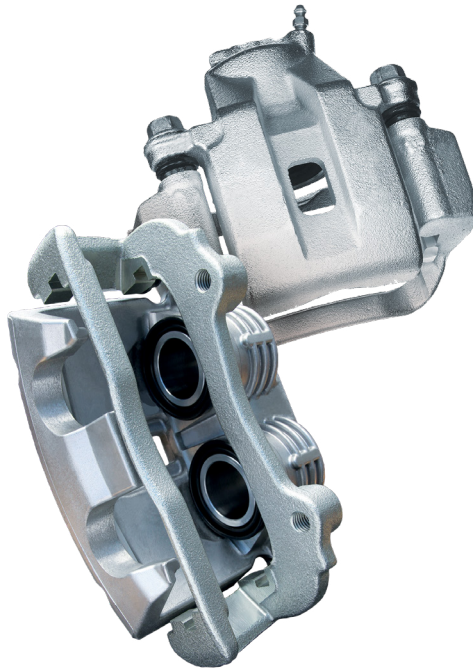

Become Part Smart Today:

<https://getpartsmart.motorcarparts.com/partsmart>



**FREE TECH HOTLINE**  
**800.228.9672**

M-F 5:30 am-5:00 pm · S-S 6:00 am-2:30 pm (PT)  
ASE Certified Bilingual Technicians Are Available

REDUCE RETURNS WITH MPAS

## CALL BEFORE YOU RETURN PROGRAM

ASE Certified Bilingual Technicians are available to help answer installation and product questions 7 days a week. In addition to product knowledge, our team can help walk you through the installation process, help verify application information, and provide tips and guidance to help get the vehicle back on the road.

## VEHICLE PREPARATION

✓ **REFER TO VEHICLE SERVICE INFORMATION FOR ANY SPECIAL TESTING, REMOVAL, OR INSTALLATION PROCEDURES**

- A) CHECK FOR ANY RELATED TECHNICAL SERVICE BULLETINS
- B) CHECK FOR AND ADDRESS ANY BRAKE-RELATED DIAGNOSTIC TROUBLE CODES AND/OR WARNING LIGHTS ON THE INSTRUMENT PANEL
- C) REFER TO ANY WARNING TAGS OR TECHNICAL BULLETINS INCLUDED IN THE BOX WITH THE REPLACEMENT CALIPER

✓ **OBTAIN ALL VEHICLE INFORMATION TO ENSURE CORRECT PART APPLICATION**

- A) MAKE, YEAR, MODEL, ENGINE, DRIVETRAIN CONFIGURATION (FWD, RWD, 4WD, AWD), BRAKE SYSTEM DETAILS, ETC.

✓ **INSPECT BRAKE PADS, BRAKE HARDWARE, BRAKE CALIPER BRACKETS, AND ROTORS FOR WEAR. REPLACE AS NECESSARY. REFER TO VEHICLE SERVICE MANUAL**

**NOTE: AFTER INSTALLING NEW BRAKE CALIPERS, IT WOULD BE AN IDEAL TIME TO FLUSH THE HYDRAULIC BRAKE SYSTEM. REFER TO THE VEHICLE SERVICE MANUAL FOR HYDRAULIC BRAKE SYSTEM FLUSHING PROCEDURE**



## Brake Caliper Removal

- ✓ ENSURE THE MASTER CYLINDER RESERVOIR LEVEL IS AT MAXIMUM FULL
- ✓ RAISE AND SUPPORT VEHICLE. REFER TO THE VEHICLE SERVICE MANUAL FOR LIFTING/JACKING INSTRUCTIONS
- ✓ REMOVE WHEEL AND TIRE ASSEMBLY
- ✓ REMOVE BRAKE HOSE CALIPER BANJO BOLT/FITTING FROM THE CALIPER
- ✓ CAP OR PLUG BRAKE CALIPER HOSE/LINE AND OPENING IN THE CALIPER TO PREVENT FLUID LOSS/CONTAMINATION. DISCARD THE TWO BRAKE HOSE WASHERS (IF APPLICABLE). **NOTE: OLD BRAKE HOSE WASHERS MAY STICK TO THE BRAKE HOSE END AND CALIPER. INSPECT BRAKE HOSES/LINES FOR WEAR AND REPLACE AS NECESSARY**
- ✓ REMOVE BRAKE CALIPER MOUNTING HARDWARE AND REMOVE THE CALIPER FROM THE BRAKE CALIPER BRACKET

IF THE REPLACEMENT CALIPER DOES NOT COME WITH THE PRE-INSTALLED BRACKET AND GUIDE PINS, INSPECT BRAKE CALIPER GUIDE-PINS OR SLIDES FOR BINDING AND WEAR. INSPECT THE GUIDE-PIN BOOTS FOR SWELLING OR TORN CONDITIONS. REPLACE ALL WORN PARTS

- ✓ **REAR CALIPER REPLACEMENT:** REMOVE PARKING BRAKE CABLE (IF APPLICABLE). **NOTE: IF THE VEHICLE IS EQUIPPED WITH ELECTRIC PARKING BRAKES, THE SYSTEM MUST BE PUT INTO SERVICE MODE.**
- ✓ **REAR CALIPER REPLACEMENT:** WHEN REMOVING BRAKE CALIPER MOUNTING HARDWARE, THE LOW-FREQUENCY VIBRATION DAMPENER MUST BE REMOVED AND TRANSFERRED TO THE REPLACEMENT BRAKE CALIPER (IF APPLICABLE). IF EQUIPPED WITH ELECTRIC PARKING BRAKES, THE PARKING BRAKE MOTOR WILL NEED TO BE REMOVED FROM THE OLD BRAKE CALIPER FOR TRANSFER TO THE NEW BRAKE CALIPER

## Brake Caliper Installation

- ✓ LUBRICATE CALIPER GUIDE-PINS (AS APPLICABLE) WITH HIGH-TEMPERATURE BRAKE GREASE AND INSTALL IN BRAKE CALIPER BRACKET WITH GUIDE-PIN BOOTS
- ✓ MOUNT THE BRAKE CALIPER TO THE BRAKE CALIPER BRACKET. IF EQUIPPED WITH CALIPER GUIDE-PINS, ENSURE CALIPER AND CALIPER GUIDE-PIN MATING SURFACES ARE FLUSH AND CORRECTLY POSITIONED
- ✓ INSTALL ALL CALIPER MOUNTING HARDWARE AND TORQUE TO MANUFACTURERS SPECIFICATIONS
- ✓ **REAR CALIPER INSTALLATION:** INSTALL THE PARKING BRAKE CABLE (IF APPLICABLE). IF EQUIPPED WITH ELECTRIC PARKING BRAKES, INSTALL THE PARKING BRAKE MOTOR TO THE BRAKE CALIPER BEFORE THE BRAKE CALIPER IS MOUNTED.
- ✓ REMOVE CAP OR PLUG FROM BRAKE HOSE/LINE
- ✓ INSTALL THE BRAKE CALIPER HOSE/LINE TO THE CALIPER. TORQUE TO MANUFACTURERS' SPECIFICATIONS. **NOTE: IF BRAKE CALIPER HOSE USES A BANJO BOLT, REPLACE WASHERS WITH NEW ONES**
- ✓ BLEED THE HYDRAULIC BRAKE SYSTEM. MAKE SURE TO USE THE CORRECT BRAKE FLUID. REFER TO THE VEHICLE SERVICE MANUAL FOR THE HYDRAULIC BRAKE SYSTEM BLEEDING PROCEDURE. CHECK HYDRAULIC BRAKE SYSTEM FOR FLUID LEAKS. CHECK FLUID LEVEL IN MASTER CYLINDER, ADD IF NECESSARY
- ✓ INSTALL THE WHEEL AND TIRE ASSEMBLY
- ✓ LOWER THE VEHICLE, TAKE THE ELECTRIC PARKING BRAKE SYSTEM OUT OF SERVICE MODE (IF APPLICABLE), AND TEST DRIVE THE VEHICLE

Become Part Smart Today:

<https://getpartsmart.motorcarparts.com/partsmart>